

Koch Classic

IMPERIAL SERIES

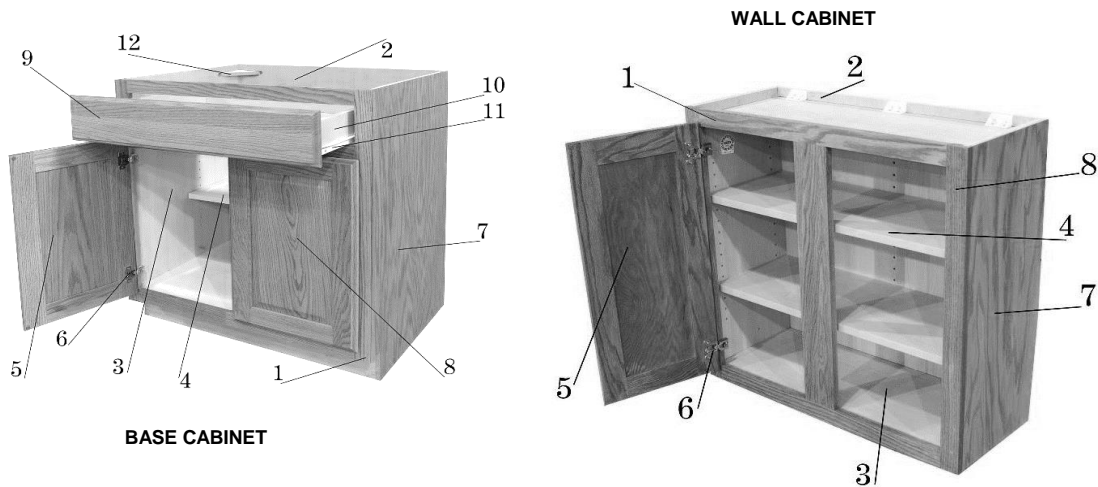

1. 3/4" HARDWOOD FACE FRAMES WITH GLUED AND POCKET SCREWED JOINTS.
2. 1/2" PLYWOOD BACK WITH MAPLE PRINT INTERIOR, ELIMINATING THE NEED FOR HANG RAILS.
3. 1/2" PLYWOOD SIDES, TOPS AND BOTTOMS, WITH MAPLE PRINT INTERIOR AND EXTERIOR.
4. 3/4" PLYWOOD SHELVING WITH MAPLE PRINT ON BOTH SIDES AND ONE EDGE. ALL SHELVES ARE ADJUSTABLE WITH BASE CABINETS HAVING 1/2 DEPTH SHELVES, SUPPORTED BY SHELF CLIPS.
5. 3/4" HARDWOOD STILE AND RAIL DOORS, MORTISE & TENON.
6. BLUM ONE PIECE ADJUSTABLE CONCEALED HINGES WITH LIFETIME WARRANTY.
DOOR UPGRADE OPTIONS:
1. BLUMOTION SOFTCLOSE HINGE
7. AVAILABLE OPTION: APPLIED 1/4" VENEERED SKINS.
8. STANDARD FINISH CONSISTS OF HAND WIPED STAIN, A COAT OF SELF SEALING CONVERSION VARNISH & A TOP COAT OF CONVERSION VARNISH. FINISH THICKNESS APPROXIMATELY 7 MIL, WET.
9. 3/4" HARDWOOD DRAWER FRONTS.
10. 1/2" RABBETED PLYWOOD DRAWER WITH 1/4" MDF FLOOR, FACED WITH MAPLE PRINT.
DRAWER UPGRADE OPTIONS:
1. 5/8" SOLID HARDWOOD DOVETAIL DRAWER WITH BLUMOTION FULL EXTENSION UNDERMOUNT SOFT CLOSE DRAWER GUIDES.
2. 5/8" SOLID HARDWOOD DOVETAIL DRAWER WITH SOFT CLOSE 7/8 EXTENSION UNDERMOUNT GUIDE.
3. 5/8" SOLID HARDWOOD DOVETAIL DRAWER WITH 3/4 EXTENSION SIDEMOUNT GUIDE.
11. SELF ADJUSTING EPOXY COATED SIDE MOUNT DRAWER GUIDES. TRACK WEIGHT RATING OF 75 POUNDS.
12. COUNTERTOP CORNER STRETCHERS ARE MADE OF PLYWOOD.

DURING INSTALLATION IF SILICONE IS GOING TO BE USED WE RECOMMEND IT BE A "NEUTRAL CURE" SILICONE. SILICONE PRODUCTS THAT CONTAIN ACETIC ACID SHOULD NOT BE USED AS IT CAN HAVE A DISCOLORING EFFECT ON THE FINISH.

KCMA CERTIFIED
MEETS KCMA ESP STANDARDS
C.A.R.B. PHASE II COMPLIANT